

# PS1600A

## 1K SANDTHROUGH SEALER



### PRODUCT DESCRIPTION

Zinc Chromate-free 1K Primer-Surfacer in a 400ml Aerosol. Designed to effectively isolate small sand-through areas, particularly at corners and edges, before application of Cromax waterborne basecoats.

### FEATURES

- 01 Good top coat flow.
- 02 Aids productivity with a fast flash-off time.
- 03 Long pot life.
- 04 Easy to use; can be applied directly to bare metal.
- 05 Medium grey in colour.

# TECHNICAL DATA SHEET



## PS1600A

## 1K SANDTHROUGH SEALER

### Product preparation - application STANDARD



It is strongly recommended to use appropriate personal protection equipment during application to avoid respiratory, skin and eye irritation.

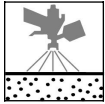

Small sanded-through spots down to the bare metal, e.g. on edges and corners, immediately before application of Waterborne Basecoat



Shake before use. (for at least 2 minutes)  
Make a spray test after shaking.

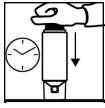

Not applicable

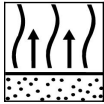

1 coat

final flash-off: 10 min - 15 min



20 °C

10 min - 15 min



If desired slight denibbing with soft pad ultra-fine.

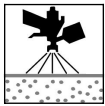

Cromax Pro Basecoat / Cromax Basecoat + Clearcoat

VOC compliant

2004/42/IB(e)(840) 730: The EU limit value for this product (product category: IIB(e)) in ready to use form is maximum 840 g/l of VOC. The VOC content of this product in ready to use form is maximum 730 g/l.

# TECHNICAL DATA SHEET



## PS1600A

## 1K SANDTHROUGH SEALER

### Products

PS1600A 1K Sandthrough Sealer



3 - 5  $\mu\text{m}$

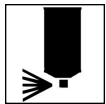

After use, hold aerosol can upside down and spray briefly to clean nozzle.

### Remarks

- Material has to be at room temperature (18-25°C) before use.
- Application distance to the substrate should be 15 until 25 cm.
- PS1600A SANDTROUGH SEALER is slightly transparent. Do not apply to coverage.

Consult Safety Data Sheet prior to use. Observe the precautionary notices displayed on the container.

All other products referred to in the refinish build up are from our Cromax product range. System properties will not be valid when the related material is used in combination with any other materials or additives which are not part of our Cromax product range, unless explicitly indicated otherwise.

For professional use only! The information provided in this documentation has been carefully selected and arranged by us. It is based upon our best knowledge on the subject at the date of issuance. The Information is given for information purposes only. We are not liable for its correctness, accuracy and completeness. It is up to the user to check the information with regard to up-to-dateness and suitability for his intended purpose. The intellectual property in this Information, including patents, trademarks and copyrights, is protected. All rights reserved. The relevant Material Safety Data Sheet and Warnings displayed on the product label need to be observed. We may modify and/ or discontinue operation of all or portions of this Information at any time in our sole discretion, without notice and assume no responsibility to update the Information. All rules set forth in this clause shall apply accordingly for any future changes and amendments.